



DIN 933 - ISO 4017 - UNI 5739 Hex Bolts

DIN 933 - ISO 4017 - UNI 5739 Sechskantschrauben

DIN 933 - ISO 4017 - UNI 5739 Boulons hexagonaux

DIN 933 - ISO 4017 - UNI 5739 Vite a testa esagonale

DIN 933 - ISO 4017 - UNI 5739 Tornillo hexagonal

Quality: 4.6 / 4.8 / 5.6 / 5.8 / 6.8 / 8.8 / 10.9 / 12.9

Coating Type: Zinc Plated / Hot Dip Galvanized / Geomet / Black Oxide

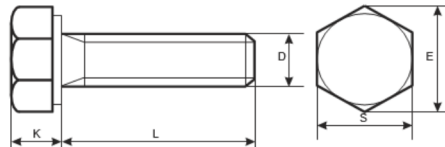

Size – D	Pitch (p)	E (Min.)	S (Min.)	S (Max.)	L	K (Min.)	K (Max.)
M8	1.25	14.38	12.57	13	FT	5.1	5.6
M10	1.5	17.77	15.57	16	FT	6.2	7
M12	1.75	20.03	17.57	18	FT	7.2	8
M16	2	26.17	23.16	24	FT	9.71	10.29
M18	2.5	29.56	26.16	27	FT	11.15	11.85
M20	2.5	32.95	29.16	30	FT	12.15	12.85
M22	2.5	37.29	33	34	FT	13.65	14.35
M24	3	39.55	35	36	FT	14.65	15.35
M27	3	45.2	40	41	FT	16.65	17.35
M30	3.5	50.85	45	46	FT	18.18	19.12
M33	3.5	55.37	49	50	FT	20.58	21.42
M36	4	60.79	53.8	55	FT	22.08	22.92
M39	4	66.44	58.8	60	FT	24.58	25.42
M42	4.5	71.3	63.1	65	FT	25.58	26.42
M45	4.5	76.95	68.1	70	FT	27.58	28.42
M48	5	82.6	73.1	75	FT	29.58	30.42
M52	5	88.25	78.1	80	FT	32.5	33.5
M56	5.5	93.56	82.8	85	FT	34.5	35.5
M60	5.5	99.21	87.8	90	FT	37.5	38.5
M64	6	104.86	92.8	95	FT	39.5	40.5

Intenfa Group Limited Company

[www.intenfa.com](http://www.intenfa.com)

[info@intenfa.com](mailto:info@intenfa.com)

INTENFA GmbH

[www.intenfa.de](http://www.intenfa.de)

[info@intenfa.de](mailto:info@intenfa.de)

INTENFA UK LIMITED

[www.intenfa.co.uk](http://www.intenfa.co.uk)

[sales@intenfa.co.uk](mailto:sales@intenfa.co.uk)

INTENFA ED S.R.L.

[www.intenfa.com](http://www.intenfa.com)

[romania@intenfa.com](mailto:romania@intenfa.com)



DIN 931 - ISO 4014 - UNI 5737 Hex Bolts

DIN 931 - ISO 4014 - UNI 5737 Sechskantschrauben

DIN 931 - ISO 4014 - UNI 5737 Boulons hexagonaux

DIN 931 - ISO 4014 - UNI 5737 Vite a testa esagonale

DIN 931 - ISO 4014 - UNI 5737 Tornillo hexagonal

Quality: 4.6 / 4.8 / 5.6 / 5.8 / 6.8 / 8.8 / 10.9 / 12.9

Coating Type: Zinc Plated / Hot Dip Galvanized / Geomet / Black Oxide

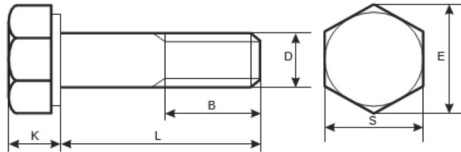

Size – D	Pitch (p)	E (Min.)	S (Min.)	S (Max.)	B		K (Min.)	K (Max.)	
					L ≤ 125	L : 125-200			
M8	1.25	14.38	12.57	13	22	28	-	5.1	5.6
M10	1.5	17.77	15.57	16	26	32	45	6.2	7
M12	1.75	20.03	17.57	18	30	36	49	7.2	8
M16	2	26.17	23.16	24	38	44	57	9.71	10.29
M18	2.5	29.56	26.16	27	42	48	61	11.15	11.85
M20	2.5	32.95	29.16	30	46	52	65	12.15	12.85
M22	2.5	37.29	33	34	50	56	69	13.65	14.35
M24	3	39.55	35	36	54	60	73	14.65	15.35
M27	3	45.2	40	41	60	66	79	16.65	17.35
M30	3.5	50.85	45	46	66	72	85	18.18	19.12
M33	3.5	55.37	49	50	72	78	91	20.58	21.42
M36	4	60.79	53.8	55	78	84	97	22.08	22.92
M39	4	66.44	58.8	60	84	90	103	24.58	25.42
M42	4.5	71.3	63.1	65	90	96	109	25.58	26.42
M45	4.5	76.95	68.1	70	96	102	115	27.58	28.42
M48	5	82.6	73.1	75	102	108	121	29.58	30.42
M52	5	88.25	78.1	80	110	116	129	32.5	33.5
M56	5.5	93.56	82.8	85	118	124	137	34.5	35.5
M60	5.5	99.21	87.8	90	-	132	145	37.5	38.5
M64	6	104.86	92.8	95	-	140	153	39.5	40.5

Intenfa Group Limited Company

[www.intenfa.com](http://www.intenfa.com)

[info@intenfa.com](mailto:info@intenfa.com)

INTENFA GmbH

[www.intenfa.de](http://www.intenfa.de)

[info@intenfa.de](mailto:info@intenfa.de)

INTENFA UK LIMITED

[www.intenfa.co.uk](http://www.intenfa.co.uk)

[sales@intenfa.co.uk](mailto:sales@intenfa.co.uk)

INTENFA ED S.R.L.

[www.intenfa.com](http://www.intenfa.com)

[romania@intenfa.com](mailto:romania@intenfa.com)

DIN 6914 - EN 14399-4 - UNI 5712 HV Hex Bolts

DIN 6914 - EN 14399-4 - UNI 5712 Sechskantschrauben

DIN 6914 - EN 14399-4 - UNI 5712 Boulons hexagonaux

DIN 6914 - EN 14399-4 - UNI 5712 Vite a testa esagonale

DIN 6914 - EN 14399-4 - UNI 5712 Tornillo hexagonal

Quality: 10.9 / 12.9

Coating Type: Zinc Plated / Hot Dip Galvanized / Geomet / Black Oxide

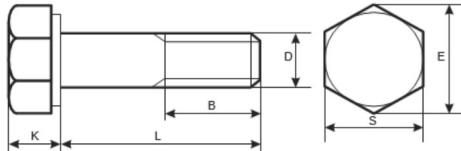

Size – D	Pitch (p)	E (Min.)	S (Min.)	S (Max.)	B (Min.)	B Max.)	K (Min.)	K (Max.)
<b>M16</b>	2	29.56	26.16	27	28	30	9.25	10.75
<b>M20</b>	2.5	35.03	31	32	33	35.5	12.1	13.9
<b>M22</b>	2.5	39.55	35	36	34	36.5	13.1	14.9
<b>M24</b>	3	45.2	40	41	39	43	14.1	15.9
<b>M27</b>	3	50.85	45	46	41	45	16.1	17.9
<b>M30</b>	3.5	55.37	49	50	44	49.5	17.95	20.05
<b>M36</b>	4	66.44	58.8	60	52	59	21.95	24.05
<b>M39</b>	4	71.3	63.1	65	68	75	23.95	26.05
<b>M42</b>	4.5	76.95	68.1	70	74	82.5	24.95	27.05
<b>M45</b>	4.5	82.6	73.1	75	76	84.5	26.95	29.05
<b>M48</b>	5	88.25	78.1	80	82	92	28.95	31.05
<b>M56</b>	5.5	99.2	87.8	90	90	101.5	33.75	36.25
<b>M64</b>	6	110.5	97.8	100	100	113	38.75	41.25

Intenfa Group Limited Company

[www.intenfa.com](http://www.intenfa.com)[info@intenfa.com](mailto:info@intenfa.com)

INTENFA GmbH

[www.intenfa.de](http://www.intenfa.de)[info@intenfa.de](mailto:info@intenfa.de)

INTENFA UK LIMITED

[www.intenfa.co.uk](http://www.intenfa.co.uk)[sales@intenfa.co.uk](mailto:sales@intenfa.co.uk)

INTENFA ED S.R.L.

[www.intenfa.com](http://www.intenfa.com)[romania@intenfa.com](mailto:romania@intenfa.com)

DIN 7990 Hex Bolts

DIN 7990 Sechskantschrauben

DIN 7990 Boulons hexagonaux

DIN 7990 Vite a testa esagonale

DIN 7990 Tornillo hexagonal

Quality: 4.6 / 5.6 / 6.8 / 8.8

Coating Type: Zinc Plated / Hot Dip Galvanized / Geomet / Black Oxide

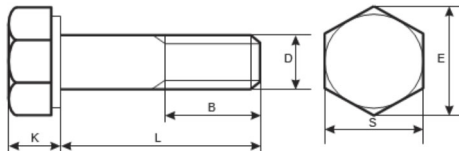

Size – D	Pitch (p)	E (Min.)	S (Min.)	S (Max.)	B	K (Min.)	K (Max.)
<b>M12</b>	1.75	20.88	18.48	19	17.75	7.55	8.45
<b>M16</b>	2	26.17	23.16	24	21	9.25	10.75
<b>M20</b>	2.5	32.95	29.16	30	23.5	12.1	13.9
<b>M22</b>	2.5	35.03	31	32	25.5	13.1	14.9
<b>M24</b>	3	39.55	35	36	26	14.1	18.9
<b>M27</b>	3	45.2	40	41	29	16.1	17.9
<b>M30</b>	3.5	50.85	45	46	30.5	17.95	20.05

Intenfa Group Limited Company

[www.intenfa.com](http://www.intenfa.com)

[info@intenfa.com](mailto:info@intenfa.com)

INTENFA GmbH

[www.intenfa.de](http://www.intenfa.de)

[info@intenfa.de](mailto:info@intenfa.de)

INTENFA UK LIMITED

[www.intenfa.co.uk](http://www.intenfa.co.uk)

[sales@intenfa.co.uk](mailto:sales@intenfa.co.uk)

INTENFA ED S.R.L.

[www.intenfa.com](http://www.intenfa.com)

[romania@intenfa.com](mailto:romania@intenfa.com)

EN 15048 SB Hex Bolts

EN 15048 SB Sechskantschrauben

EN 15048 SB Boulons hexagonaux

EN 15048 SB Vite a testa esagonale

EN 15048 SB Tornillo hexagonal

Quality: 8.8 / 10.9 - **SB MARKING**

Coating Type: Zinc Plated / Hot Dip Galvanized / Geomet / Black Oxide

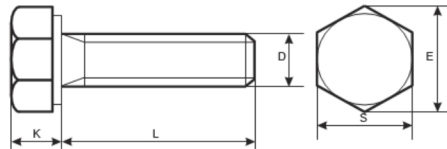

Size – D	Pitch (p)	E (Min.)	S (Min.)	S (Max.)	L	K (Min.)	K (Max.)
<b>M12</b>	1.75	20.03	17.57	18	FT	7.2	8
<b>M16</b>	2	26.17	23.16	24	FT	9.71	10.29
<b>M20</b>	2.5	32.95	29.16	30	FT	12.15	12.85
<b>M24</b>	3	39.55	35	36	FT	14.65	15.35
<b>M30</b>	3.5	50.85	45	46	FT	18.18	19.12
<b>M36</b>	4	60.79	53.8	55	FT	22.08	22.92

Intenfa Group Limited Company

[www.intenfa.com](http://www.intenfa.com)[info@intenfa.com](mailto:info@intenfa.com)

INTENFA GmbH

[www.intenfa.de](http://www.intenfa.de)[info@intenfa.de](mailto:info@intenfa.de)

INTENFA UK LIMITED

[www.intenfa.co.uk](http://www.intenfa.co.uk)[sales@intenfa.co.uk](mailto:sales@intenfa.co.uk)

INTENFA ED S.R.L.

[www.intenfa.com](http://www.intenfa.com)[romania@intenfa.com](mailto:romania@intenfa.com)

ASME B18.2.1 - ASTM A193 Hex Bolts  
 ASME B18.2.1 - ASTM A193 Sechskantschrauben  
 ASME B18.2.1 - ASTM A193 Boulons hexagonaux  
 ASME B18.2.1 - ASTM A193 Vite a testa esagonale  
 ASME B18.2.1 - ASTM A193 Tornillo hexagonal



Quality: B7, B7M, B16

Coating Type: Zinc Plated / Hot Dip Galvanized / Geomet / Black Oxide

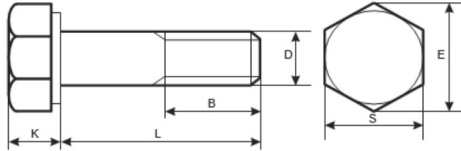

Size – INCH	Pitch-UNC	E (Min.)	E (Max.)	S (Min.)	S (Max.)	B <6"(s)	B >6"(L)	K (Min.)	K (Max.)
1/2	13	0.84	0.866	0.736	0.750	1.250	1.500	0.302	0.323
9/16	12	0.91	0.938	0.798	0.812	1.375	1.625	0.348	0.371
5/8	11	1.051	1.083	0.922	0.938	1.500	1.750	0.378	0.403
3/4	10	1.254	1.299	1.100	1.125	1.750	2.000	0.455	0.483
7/8	9	1.465	1.516	1.285	1.312	2.000	2.250	0.531	0.563
1	8	1.675	1.732	1.469	1.500	2.250	2.500	0.591	0.627
1-1/8	8	1.859	1.949	1.631	1.688	2.500	2.750	0.658	0.718
1-1/4	8	2.066	2.165	1.812	1.875	2.750	3.000	0.749	0.813
1-3/8	8	2.273	2.382	1.994	2.062	3.000	3.250	0.810	0.878
1-1/2	8	2.48	2.598	2.175	2.250	3.250	3.500	0.902	0.974
1-5/8	8	2.686	2.815	2.356	2.438	3.500	3.750	0.962	1.038
1-3/4	8	2.893	3.031	2.538	2.625	3.750	4.000	1.054	1.134
1-7/8	8	3.099	3.248	2.719	2.812	4.000	4.250	1.114	1.198
2	8	3.306	3.464	2.900	3.000	4.250	4.500	1.175	1.263
2-1/4	8	3.719	3.897	3.262	3.375	-	5.000	1.327	1.423
2-1/2	8	4.133	4.33	3.625	3.750	-	5.500	1.479	1.583
2-3/4	8	4.546	4.763	3.988	4.125	-	6.000	1.632	1.744
3	8	4.959	5.196	4.350	4.500	-	6.500	1.815	1.935

Intenfa Group Limited Company

[www.intenfa.com](http://www.intenfa.com)

[info@intenfa.com](mailto:info@intenfa.com)

INTENFA GmbH

[www.intenfa.de](http://www.intenfa.de)

[info@intenfa.de](mailto:info@intenfa.de)

INTENFA UK LIMITED

[www.intenfa.co.uk](http://www.intenfa.co.uk)

[sales@intenfa.co.uk](mailto:sales@intenfa.co.uk)

INTENFA ED S.R.L.

[www.intenfa.com](http://www.intenfa.com)

[romania@intenfa.com](mailto:romania@intenfa.com)

**ASME B18.2.6M Hex Bolts**

**ASME B18.2.6M Sechskantschrauben**

**ASME B18.2.6M Boulons hexagonaux**

**ASME B18.2.6M Vite a testa esagonale**

**ASME B18.2.6M Tornillo hexagonal**

**Quality: ASTM A325M or ASTM A490M**

**Coating Type: Zinc Plated / Hot Dip Galvanized / Geomet / Black Oxide**

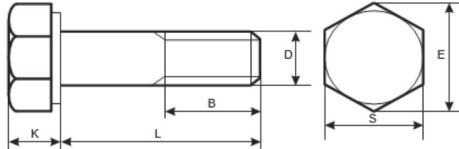

Size – D	Pitch-UNC	E (Min.)	E (Max.)	S (Min.)	S (Max.)	B (Ref.)	K (Min.)	K (Max.)
<b>M12</b>	1.75	22.78	24.25	20.16	21	25	7.05	7.95
<b>M16</b>	2	29.56	31.18	26.16	27	31	9.25	10.75
<b>M20</b>	2.5	37.29	39.26	33	34	36	11.6	13.4
<b>M22</b>	2.5	29.55	41.57	35	36	38	13.1	14.9
<b>M24</b>	3	45.20	47.34	50	41	41	14.1	15.9
<b>M27</b>	3	50.85	53.12	45	46	44	16.1	17.9
<b>M30</b>	3.5	55.27	57.74	49	50	49	17.65	19.75
<b>M36</b>	4	66.44	69.28	58.8	60	56	21.45	23.55

Intenfa Group Limited Company

[www.intenfa.com](http://www.intenfa.com)

[info@intenfa.com](mailto:info@intenfa.com)

INTENFA GmbH

[www.intenfa.de](http://www.intenfa.de)

[info@intenfa.de](mailto:info@intenfa.de)

INTENFA UK LIMITED

[www.intenfa.co.uk](http://www.intenfa.co.uk)

[sales@intenfa.co.uk](mailto:sales@intenfa.co.uk)

INTENFA ED S.R.L.

[www.intenfa.com](http://www.intenfa.com)

[romania@intenfa.com](mailto:romania@intenfa.com)

ASME B18.2.1 - ASTM A307 Hex Bolts  
 ASME B18.2.1 - ASTM A307 Sechskantschrauben  
 ASME B18.2.1 - ASTM A307 Boulons hexagonaux  
 ASME B18.2.1 - ASTM A307 Vite a testa esagonale  
 ASME B18.2.1 - ASTM A307 Tornillo hexagonal



Quality: 307A, 307B, 307C

Coating Type: Zinc Plated / Hot Dip Galvanized / Geomet / Black Oxide

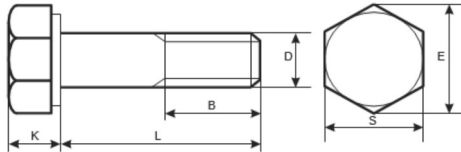

Size – INCH	Pitch-UNC	E (Min.)	E (Max.)	S (Min.)	S (Max.)	B <6"(s)	B >6"(L)	K (Min.)	K (Max.)
1/2	13	0.84	0.866	0.736	0.750	1.250	1.500	0.302	0.323
9/16	12	0.91	0.938	0.798	0.812	1.375	1.625	0.348	0.371
5/8	11	1.051	1.083	0.922	0.938	1.500	1.750	0.378	0.403
3/4	10	1.254	1.299	1.100	1.125	1.750	2.000	0.455	0.483
7/8	9	1.465	1.516	1.285	1.312	2.000	2.250	0.531	0.563
1	8	1.675	1.732	1.469	1.500	2.250	2.500	0.591	0.627
1-1/8	8	1.859	1.949	1.631	1.688	2.500	2.750	0.658	0.718
1-1/4	8	2.066	2.165	1.812	1.875	2.750	3.000	0.749	0.813
1-3/8	8	2.273	2.382	1.994	2.062	3.000	3.250	0.810	0.878
1-1/2	8	2.48	2.598	2.175	2.250	3.250	3.500	0.902	0.974
1-5/8	8	2.686	2.815	2.356	2.438	3.500	3.750	0.962	1.038
1-3/4	8	2.893	3.031	2.538	2.625	3.750	4.000	1.054	1.134
1-7/8	8	3.099	3.248	2.719	2.812	4.000	4.250	1.114	1.198
2	8	3.306	3.464	2.900	3.000	4.250	4.500	1.175	1.263
2-1/4	8	3.719	3.897	3.262	3.375	-	5.000	1.327	1.423
2-1/2	8	4.133	4.33	3.625	3.750	-	5.500	1.479	1.583
2-3/4	8	4.546	4.763	3.988	4.125	-	6.000	1.632	1.744
3	8	4.959	5.196	4.350	4.500	-	6.500	1.815	1.935

Intenfa Group Limited Company

[www.intenfa.com](http://www.intenfa.com)

[info@intenfa.com](mailto:info@intenfa.com)

INTENFA GmbH

[www.intenfa.de](http://www.intenfa.de)

[info@intenfa.de](mailto:info@intenfa.de)

INTENFA UK LIMITED

[www.intenfa.co.uk](http://www.intenfa.co.uk)

[sales@intenfa.co.uk](mailto:sales@intenfa.co.uk)

INTENFA ED S.R.L.

[www.intenfa.com](http://www.intenfa.com)

[romania@intenfa.com](mailto:romania@intenfa.com)



DIN 960 - UNI 5738 Hex Bolts

DIN 960 - UNI 5738 Sechskantschrauben

DIN 960 - UNI 5738 Boulons hexagonaux

DIN 960 - UNI 5738 Vite a testa esagonale

DIN 960 - UNI 5738 Tornillo hexagonal

Quality: 4.6 / 4.8 / 5.6 / 5.8 / 6.8 / 8.8 / 10.9 / 12.9

Coating Type: Zinc Plated / Hot Dip Galvanized / Geomet / Black Oxide

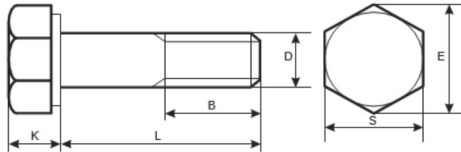

Size – D	Pitch (p)	E (Min.)	S (Min.)	S (Max.)	B			K (Min.)	K (Max.)
					L ≤ 125	L : 125-200	L ≥ 200		
M8	1	14.38	12.57	13	22	28	-	5.1	5.6
M10	1- 1.25	18.72	16.57	17	26	32	45	6.2	7
M12	1.25 – 1.5	20.88	18.48	19	30	36	49	7.2	8
M14	1.5	23.91	21.16	22	34	40	53	9	8
M16	1.5	26.17	23.16	24	38	44	57	9.71	10.29
M18	1.5 – 2	29.56	26.16	27	42	48	61	11.15	11.85
M20	1.5 – 2	32.95	29.16	30	46	52	65	12.15	12.85
M22	1.5 – 2	37.29	33	34	50	56	69	13.65	14.35
M24	1.5 – 2	39.55	35	36	54	60	73	14.65	15.35
M27	2	45.2	40	41	60	66	79	16.65	17.35
M30	2	50.85	45	46	66	72	85	18.18	19.12
M33	2	55.37	49	50	72	78	91	20.58	21.42
M36	3	60.79	53.8	55	78	84	97	22.08	22.92
M39	3	66.44	58.8	60	84	90	103	24.58	25.42
M42	3	71.3	63.1	65	90	96	109	25.58	26.42
M45	3	76.95	68.1	70	96	102	115	27.58	28.42
M48	3	82.6	73.1	75	102	108	121	29.58	30.42
M52	3	88.25	78.1	80	110	116	129	32.5	33.5

Intenfa Group Limited Company

[www.intenfa.com](http://www.intenfa.com)[info@intenfa.com](mailto:info@intenfa.com)

INTENFA GmbH

[www.intenfa.de](http://www.intenfa.de)[info@intenfa.de](mailto:info@intenfa.de)

INTENFA UK LIMITED

[www.intenfa.co.uk](http://www.intenfa.co.uk)[sales@intenfa.co.uk](mailto:sales@intenfa.co.uk)

INTENFA ED S.R.L.

[www.intenfa.com](http://www.intenfa.com)[romania@intenfa.com](mailto:romania@intenfa.com)

DIN 961 - UNI 5738 Hex Bolts

DIN 961 - UNI 5738 Sechskantschrauben

DIN 961 - UNI 5738 Boulons hexagonaux

DIN 961 - UNI 5738 Vite a testa esagonale

DIN 961 - UNI 5738 Tornillo hexagonal

Quality: 4.6 / 4.8 / 5.6 / 5.8 / 6.8 / 8.8 / 10.9 / 12.9

Coating Type: Zinc Plated / Hot Dip Galvanized / Geomet / Black Oxide

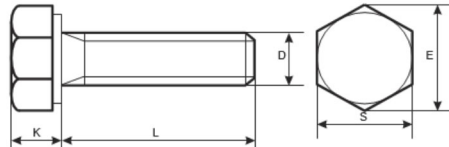

Size – D	Pitch (p)	E (Min.)	S (Min.)	S (Max.)	L	K (Min.)	K (Max.)
M8	1	14.38	12.57	13	FT	5.1	5.6
M10	1- 1.25	18.72	16.57	17	FT	6.2	7
M12	1.25 – 1.5	20.88	18.48	19	FT	7.2	8
M14	1.5	23.91	21.16	22	FT	9	8
M16	1.5	26.17	23.16	24	FT	9.71	10.29
M18	1.5 – 2	29.56	26.16	27	FT	11.15	11.85
M20	1.5 – 2	32.95	29.16	30	FT	12.15	12.85
M22	1.5 – 2	37.29	33	34	FT	13.65	14.35
M24	1.5 – 2	39.55	35	36	FT	14.65	15.35
M27	2	45.2	40	41	FT	16.65	17.35
M30	2	50.85	45	46	FT	18.18	19.12
M33	2	55.37	49	50	FT	20.58	21.42
M36	3	60.79	53.8	55	FT	22.08	22.92
M39	3	66.44	58.8	60	FT	24.58	25.42
M42	3	71.3	63.1	65	FT	25.58	26.42
M45	3	76.95	68.1	70	FT	27.58	28.42
M48	3	82.6	73.1	75	FT	29.58	30.42
M52	3	88.25	78.1	80	FT	32.5	33.5

Intenfa Group Limited Company

[www.intenfa.com](http://www.intenfa.com)[info@intenfa.com](mailto:info@intenfa.com)

INTENFA GmbH

[www.intenfa.de](http://www.intenfa.de)[info@intenfa.de](mailto:info@intenfa.de)

INTENFA UK LIMITED

[www.intenfa.co.uk](http://www.intenfa.co.uk)[sales@intenfa.co.uk](mailto:sales@intenfa.co.uk)

INTENFA ED S.R.L.

[www.intenfa.com](http://www.intenfa.com)[romania@intenfa.com](mailto:romania@intenfa.com)

**DIN 6921 - Hexagon Flange Bolts**

**DIN 6921 - Sechskantschrauben mit Flansch**

**DIN 6921 - Boulons à embase et tête hexagonale**

**DIN 6921 - Vite Testa Esagonale flangiata**

**DIN 6921 - Tornillos cabeza hexagonal**

**Quality: 8.8 / 10.9 / 12.9**

**Coating Type: Zinc Plated / Hot Dip Galvanized / Geomet / Black Oxide**

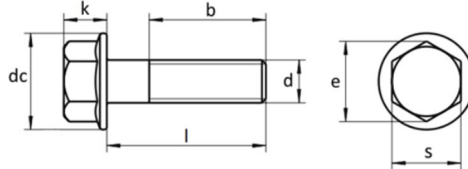

Size – D	Pitch (p)	L	B			S	K
			L ≤ 125	125 < L ≤ 200	L > 200		
<b>M8</b>	1 – 1.25	16-80	22	28	-	13	8.10
<b>M10</b>	1 – 1.25 – 1.5	20-150	26	32	-	15	9.20
<b>M12</b>	1.25 – 1.5 – 1.75	25-200	30	36	-	16	11.50
<b>M14</b>	1.5 – 2	30-250	34	40	-	18	12.80
<b>M16</b>	1.5 – 2	35-500	38	44	57	21	14.40
<b>M20</b>	2.5 – 1.5	40-600	46	52	65	27	17.1

Intenfa Group Limited Company

[www.intenfa.com](http://www.intenfa.com)

[info@intenfa.com](mailto:info@intenfa.com)

INTENFA GmbH

[www.intenfa.de](http://www.intenfa.de)

[info@intenfa.de](mailto:info@intenfa.de)

INTENFA UK LIMITED

[www.intenfa.co.uk](http://www.intenfa.co.uk)

[sales@intenfa.co.uk](mailto:sales@intenfa.co.uk)

INTENFA ED S.R.L.

[www.intenfa.com](http://www.intenfa.com)

[romania@intenfa.com](mailto:romania@intenfa.com)

DIN 186 - T-Head bolts

DIN 186 - Hammerkopfschrauben

DIN 186 - Boulons à tête en T

DIN 186 - Bulloni con testa a martello

DIN 186- Tornillos con cabeza en T

Quality: 4.6 / 4.8 / 5.6 / 5.8 / 6.8 / 8.8 / 10.9 / 12.9

Coating Type: Zinc Plated / Hot Dip Galvanized / Geomet / Black Oxide

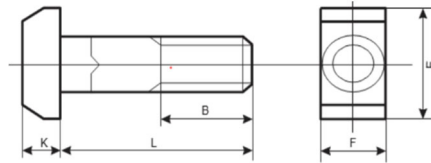

Size – D	Pitch (p)	E	F	K	B	
					L ≤ 140	L ≥ 140
M16	2	30	16	10.5	38	44
M20	2.5	36	20	13	46	52
M24	3	43	24	15	54	60
M30	3.5	54	30	19	66	72
M36	4	66	36	23	78	84
M42	4.5	80	42	26	90	96
M48	5	88	48	30	102	108

Intenfa Group Limited Company

[www.intenfa.com](http://www.intenfa.com)

[info@intenfa.com](mailto:info@intenfa.com)

INTENFA GmbH

[www.intenfa.de](http://www.intenfa.de)

[info@intenfa.de](mailto:info@intenfa.de)

INTENFA UK LIMITED

[www.intenfa.co.uk](http://www.intenfa.co.uk)

[sales@intenfa.co.uk](mailto:sales@intenfa.co.uk)

INTENFA ED S.R.L.

[www.intenfa.com](http://www.intenfa.com)

[romania@intenfa.com](mailto:romania@intenfa.com)

**DIN 912 - Hexagon socket Head Cap Screws**

**DIN 912 - Zylinderschraube mit Innensechskant**

**DIN 912 - Vis à tête cylindrique à six pans creux**

**DIN 912 - Viti a testa cilindrica con cava esagonale**

**DIN 912 - Tornillos con cabeza hueca hexagonal**

**Quality: 8.8 / 10.9 / 12.9**

**Coating Type: Zinc Plated / Hot Dip Galvanized / Geomet / Black Oxide**

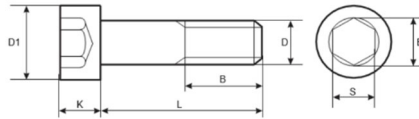

Size – D	Pitch (p)	E (Min.)	S	K	B
<b>M16</b>	2	16	14	16	44
<b>M20</b>	2.5	19.5	17	20	52
<b>M24</b>	3	21.73	19	24	60
<b>M30</b>	3.5	25.15	22	30	72
<b>M36</b>	4	30.85	27	36	84
<b>M42</b>	4.5	36.57	32	42	96
<b>M48</b>	5	41.13	36	48	108
<b>M56</b>	5.5	46.83	41	56	124
<b>M64</b>	6	52.53	46	64	140

Intenfa Group Limited Company

[www.intenfa.com](http://www.intenfa.com)

[info@intenfa.com](mailto:info@intenfa.com)

INTENFA GmbH

[www.intenfa.de](http://www.intenfa.de)

[info@intenfa.de](mailto:info@intenfa.de)

INTENFA UK LIMITED

[www.intenfa.co.uk](http://www.intenfa.co.uk)

[sales@intenfa.co.uk](mailto:sales@intenfa.co.uk)

INTENFA ED S.R.L.

[www.intenfa.com](http://www.intenfa.com)

[romania@intenfa.com](mailto:romania@intenfa.com)

**DIN 561 - Hex Bolts**

**DIN 561 - Sechskantschrauben**

**DIN 561 - Boulons hexagonaux**

**DIN 561 - Vite a testa esagonale**

**DIN 561 - Tornillo hexagonal**

**Quality: 8.8 / 10.9 / 12.9**

**Coating Type: Zinc Plated / Hot Dip Galvanized / Geomet / Black Oxide**

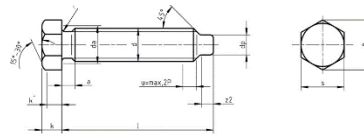

Size – D	Pitch (p)	E (Min.)	S	K	Z2	DP
<b>M16</b>	2	19.92	18	11	8.36	12
<b>M20</b>	2.5	26.75	24	14	10.36	15
<b>M24</b>	3	33.53	30	17	12.43	18
<b>M30</b>	3.5	38.98	36	21	15.43	23
<b>M36</b>	4	51.28	46	25	18.43	28
<b>M42</b>	4.5	61.31	55	30	21.52	32
<b>M48</b>	5	72.61	65	34	24.52	38
<b>M56</b>	5.5	83.91	75	40	28.52	45

**Intenfa Group Limited Company**

[www.intenfa.com](http://www.intenfa.com)

[info@intenfa.com](mailto:info@intenfa.com)

**INTENFA GmbH**

[www.intenfa.de](http://www.intenfa.de)

[info@intenfa.de](mailto:info@intenfa.de)

**INTENFA UK LIMITED**

[www.intenfa.co.uk](http://www.intenfa.co.uk)

[sales@intenfa.co.uk](mailto:sales@intenfa.co.uk)

**INTENFA ED S.R.L.**

[www.intenfa.com](http://www.intenfa.com)

[romania@intenfa.com](mailto:romania@intenfa.com)

**DIN 609 - Hex Bolts**

**DIN 609 - Sechskantschrauben**

**DIN 609 - Boulons hexagonaux**

**DIN 609 - Vite a testa esagonale**

**DIN 609 - Tornillo hexagonal**

**Quality: 8.8 / 10.9 / 12.9**

**Coating Type: Zinc Plated / Hot Dip Galvanized / Geomet / Black Oxide**

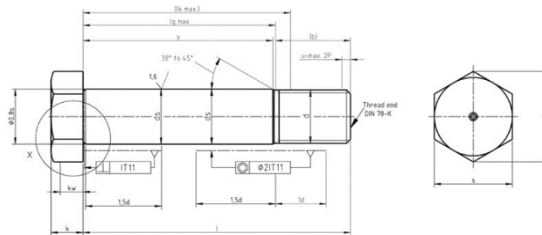

Size – D	Pitch (p)	E (Min.)	S	K	B		
					L ≤ 50	50 ≤ L ≤ 150	L ≥ 150
<b>M16</b>	1.5	26.17	24	10	25	27	32
<b>M20</b>	2	32.95	30	12.5	28.5	30.5	35.5
<b>M24</b>	2	39.55	36	15	-	36.5	41.5
<b>M30</b>	2	50.85	46	19	-	43	48
<b>M36</b>	3	60.79	55	22	-	49	54
<b>M42</b>	3	71.3	65	26	-	56	61
<b>M48</b>	3	82.6	75	30	-	63	68

**Intenfa Group Limited Company**

[www.intenfa.com](http://www.intenfa.com)

[info@intenfa.com](mailto:info@intenfa.com)

**INTENFA GmbH**

[www.intenfa.de](http://www.intenfa.de)

[info@intenfa.de](mailto:info@intenfa.de)

**INTENFA UK LIMITED**

[www.intenfa.co.uk](http://www.intenfa.co.uk)

[sales@intenfa.co.uk](mailto:sales@intenfa.co.uk)

**INTENFA ED S.R.L.**

[www.intenfa.com](http://www.intenfa.com)

[romania@intenfa.com](mailto:romania@intenfa.com)